

97% of the
Earth is
unpaved...
Get out there
and explore it!



IVIGAS



OUR STORY

MOAB

The world of high-end motorhomes that are truly off-road and truly off-grid capable is a small one. The reality is that there are a lot of pretenders. Don't overpay for something that may look good on the outside, but inside, behind the bells and whistles is where it counts and that is where MOAB excels! When we set out to design one of the best



performing, highest quality extreme motorhomes on the market, MOAB did our homework and brought our combined 100+ years of experience building the highest quality motorhomes to the table. The result is the MOAB Juggernaut, built on the ACELA military grade chassis, and the MOAB Trailblazer, featuring the same superior construction, on a truck chassis designed specifically for extreme off the grid living - all at a fraction of the cost of less capable products on the market.

MOAB constructs each of our extreme motorhomes using only the highest quality materials and methodology. Starting with high-grade, thick, welded tubular steel and aluminum, MOAB goes the extra mile when assembling our coaches by utilizing huck bolt fasteners to secure our roof to our sidewalls and our sidewalls to our floor.

Why use huck bolts? Because they form a permanent, high-strength joint. In fact, huck bolts have been tested to provide 20% higher tensile strength and are used in the

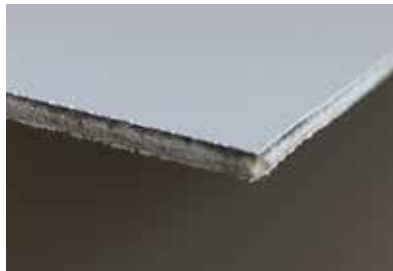

production of locomotives - that's why! Our exterior fiberglass walls are the thickest in

the industry with no wood backing so you don't have to worry about delamination. Our thick, 1/4" fiberglass wall covering is built to stand the test of time and extreme elements.

We build our unique MOAB motorhomes one at a time, paying careful attention to details. We then mount our motorhome box on a variety of chassis options, including the ACELA chassis, which is a former military chassis with unmatched off-road capabilities, as well as a 550 truck chassis that has been modified to provide our customers with the smoothest ride possible when driving through brush, streams, or mountain ravines. The MOAB Juggernaut is mounted on a floating platform that is separate from the chassis which allows the vehicle to twist and torque as it traverses rugged terrain and





uneven surfaces without putting undue stress on the motorhome box structure.

Shown to the left is the MOAB Juggernaut. Shown below is the MOAB Trailblazer.

A nearly 8' tall engine snorkel allows the MOAB Juggernaut to traverse small rivers without flooding the engine. MOAB is committed to providing the highest quality experience for our customers. A number of our chassis have served time overseas in the service of the U.S. Army.

The electrical storage systems in the MOAB extreme off-road motorhomes are second to none and provide our owners

with the ability to enjoy extended periods of time off the grid with no need for a generator.

TAKE THE TIME TO COMPARE!

INDUSTRY LEADING OFF-GRID ELECTRICAL SYSTEM -

- **48 Volt Energy System.** NOTE: Our 48 Volt System is 2 Times more efficient than leading competitors 24 Volt systems and 4 times more efficient than a 12 Volt system!
- **50 Amp Service**
- **6000 Watts** of inverter power
- Available Run Time:
 - Max A/C- Leading industry at **21 Hours**
 - Running Full System (Heater, A/C, Microwave, Cooktop, etc.) at **10 Hours** (Solar/Alternator/Shore power adds additional time)
- Recharge Time if operating at full capacity, **Less than 5 hours**
- Recharge Time if operating at full capacity with sunlight/solar, **just over 3 Hours**
- **17 Kilowatts**-Energy Storage System
- **Two (2) 8440Watt** Hour Module Lithionics UL listed Lithium-Ion Batteries

- **1.5 Kilowatts-Merlin Flexible Solar Panels** for supplemental charging
- Market leading remote interface w/ Bluetooth and Wi-Fi based app
- Victron Touch screen control panel provides state of the art system control and monitoring
- 120V AC outlets located in front overhead, dinette, kitchen, washer/dryer cabinet, bathroom and storage area
- 20 Amp AC outlet in compartment



To many people focus on more amp hours - but what is most important is what you do with them and MOAB's 48V system maximizes amp hours unlike any other vehicle on the market!

MOAB's Dual 3,000 Watt Invertors provide for extended periods of offgrid time for our customers!

MOAB

Did we tell you about the INSIDE of the MOAB extreme motorhome? The best way to describe it is refined luxury. Featuring quality built, residential style cabinetry and solid surface countertops, you will think that you are staying in a luxury hotel, not in the outback!



The luxurious kitchen features residential style appliances and features a large refrigerator, cooktop stove that can be removed and utilized outside on a table, and an under-counter convection/microwave oven provides even more flexibility when cooking.

A sink cover provides extra counter space when not using the sink.





MOAB

NEVER SQUEEZE INTO A SMALL WET BATH AGAIN!

While you may be traversing some of the roughest terrain ever in your MOAB extreme motorhome, you will never have to “rough it” again with our luxurious, spacious bathroom suite! Featuring a large shower with plenty of elbow room, a separate toilet area, roomy lav base and TONS of storage for more than just your toiletries and towels the MOAB bathroom is unlike anything you have seen in an extreme motorhome.

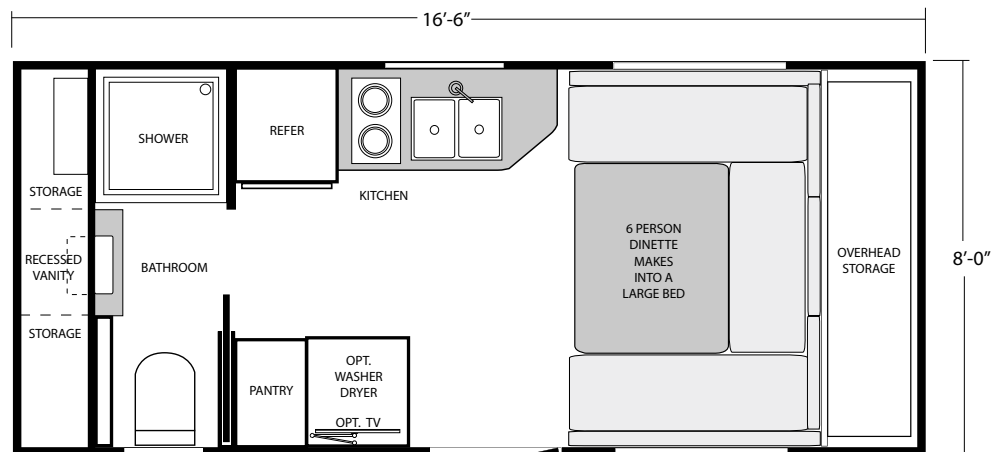

MOAB 16X

MOAB

TRAILBLAZER



The interior of the MOAB Trailblazer model features a nice sized cab-over area which offers extra sleeping accommodations.

A curtain provides extra privacy for those sleeping in the cab-over bed.



The roomy dinette booth quickly converts to a large bed, and there is also a drop-down bed option from the ceiling available.

An access hatch to the cab of the truck can be found under the mattress in the cab-over area.





MOAB

MIGAB

JUGGERNAUT

EXTREME OFFROAD - OFFGRID MOTORHOME

CHASSIS -

- ACELA Monterra 4x4 Extreme-Duty Class 6-7 Cab & Chassis
- Full-Time All-Wheel Drive
- 330HP Caterpillar 7.2L Turbo-Charged Diesel Engine
- Allison Automatic 7-Speed Transmission
- Top Speed 74 MPH
- Former Military Vehicle w/U.S Army "Ultra-Reliable" Certificate
- 22" Ground Clearance
- Air-Ride Seating
- Cameras: Back-up/left/right turn viewing on 7" viewing screen
- Dash mounted stereo (AM/FM/DVD) w/6.2" Touchscreen
- Central Tire Inflation System (CTIS)
- Dash Switches for lighting controls
- 58 Gallon Fuel tank offers approx. 400+ mile range
- Power steering assist
- Parabolic-tapered leaf springs w/ hydraulic twin-tube shocks
- ABS brakes with supplemental air-actuated driver controlled exhaust "Jake" brake
- 46" Goodyear MV/T, 14-Ply, 81MPH-Rated Tires, Load-Range G Super Singles
- Rack-Mounted, Hydraulic Lift for spare tire
- Dual Voltage, 12/24VDC, Central Power Distribution panel
- 100 amp, 12/24 volt, Waterproof, EMI/RFI Suppressed
- Four (4)-6T Commercial Batteries, 3000 CCA, 480 CA

EXTERIOR -

- RS designed body/frame that is self-supporting. Doesn't need a monocoque shell to support itself. Box frame structure is welded and huck fastened together for maximum strength
- Exterior entry/exit with articulating step
- Grab handle and railing at entry door for extra convenience
- Multiple metal storage areas with lockable doors
- Fully painted body to match truck
- All tanks are easily accessible through exterior storage doors
- All components are self-contained within the structure of the shell, allowing the habitat to be unbolted from chassis

EXTERIOR LIGHTING -

- 52" LED light bar on front of cab
- LED tail and brake lights, upper and lower, & marker lights
- LED reverse lights
- LED rear license plate light
- Fog lights
- OEM driving lights
- 3-LED 12" security lights

INTERIOR -

- Large dining table with seating for 6, converts to a King Bed
- High ceilings w/premium soft touch headliner
- Closet w/shelves and hanging rod
- Under dinette storage
- Cab over storage
- Commercial grade flooring for easy cleaning
- Premium seating material
- Commercial grade laminate cabinets w/soft close mechanism
- Push button latches
- Solid surface countertops throughout

INTERIOR LIGHTING -

- Zoned lighting throughout
- Independent on/off switches for overheads, bathroom, dinette, kitchen and outside security lights

GALLEY -

- Residential style stainless-steel sink w/ large faucet
- Under cabinet storage for trash can
- Residential style solid surface countertops
- Removable-double burner induction cooktop. Take outside and plug in at your convenience
- Convection microwave/oven
- Refrigerator/freezer
- Exhaust hood
- Overhead cabinet storage
- Base cabinet storage
- Washer/dryer cabinet with pull out storage drawer
- Countertop space with outlets for charging computer or coffee pot
- Wall mounted Smart TV
- Ceiling skylight for roof access above dinette table

BATHROOM -

- Residential style, fully dry, enclosed bathroom with toilet
- Residential style walk-in shower
- Vanity mirror
- Floor to ceiling storage cabinet beside toilet
- Lower cabinet storage w/pass-through to rear exterior storage
- Removable shower wand on height adjustable slide bar
- Sink with premium fixtures
- Premium toilet paper holder
- Shower has skylight for extra lighting and head room
- Variable speed exhaust fan with rain cover

MOAB

JUGGERNAUT

EXTREME OFFROAD - OFFGRID MOTORHOME

INDUSTRY LEADING OFF-GRID ELECTRICAL SYSTEM -

- **48 Volt Energy System.** NOTE: Our 48 Volt System is 2 Times more efficient than leading competitors 24 Volt systems and 4 times more efficient than a 12 Volt system!
- **50 Amp Service**
- **6000 Watts** of inverter power
- Available Run Time:
 - Max A/C- Leading industry at **21 Hours**
 - Running Full System (Heater, A/C, Microwave, Cooktop, etc.) at **10 Hours** (Solar/Alternator/Shore power adds additional time)
- Recharge Time if operating at full capacity, **Less than 5 hours**
- Recharge Time if operating at full capacity with sunlight/solar, **just over 3 Hours**
- **17 Kilowatts**-Energy Storage System
- **Two (2) 8440Watt** Hour Module Lithionics UL listed Lithium-Ion Batteries
- **1.5 Kilowatts**-Merlin Flexible Solar Panels for supplemental charging
- Market leading remote interface w/ Bluetooth and Wi-Fi based app
- Victron Touch screen control panel provides state of the art system control and monitoring
- 120V AC outlets located in front overhead, dinette, kitchen, washer/dryer cabinet, bathroom and storage area
- 20 Amp AC outlet in compartment

SPECIFICATIONS -

Overall Length: 25' - 3"
Overall Height (w/AC): 12' - 8"
Interior Height: 81.5" ()
Wheelbase: 153.5"

Overall Width: 97"
Interior Width: 92.5"

GVWR: 32,000 lbs.

TANK CAPACITIES -

- 150 Gallons of Fresh Water
- 40 Gallon waste tank
- 30 Gallon grey tank

AIR CONDITIONING, HEATING, & VENTILATION -

- Nomadic Cooling, 3000 48 Volt A/C, 12,480 BTU; Comes standard with 48 Volt brushless motor; Highly efficient while Reducing noise and Increases motor life
- Two (2) thermostat controlled toe kick heaters
- Dual pane windows fully open to bring the outside in
- Roof hatch with vent fan, screen and escape hatch

PLUMBING -

- Two (2) 75 Gallon self-contained and heated fresh water holding tanks w/manual drain valve (total 150 Gallons of fresh water)
- 40 Gallon self-contained and heated waste black tank w/manual drain valve
- 30 Gallon self-contained and heated waste grey tank w/manual drain valve
- Tank monitoring system
- High-capacity water pump
- 10-Gallon water heater
- Exterior shower with hot and cold water

SAFETY -

- Carbon Monoxide/smoke detector
- Fire extinguisher
- Roadside safety kit

ACCESSORIES -

- Fresh water hose
- Waste tank hose
- Axe and shovel mounted in rear storage area
- Metal Constructed Storage boxes built into sub-floor frame
- 50 Amp shore cord

Contact your Dealer or MOAB for more detailed information.
Ask about customizing your coach if you see anything
you may want that we do not currently offer.

The information contained in this promotional brochure was put together using the latest information available at the time of printing. For the most up to date and current specifications, contact your nearest dealer or Recreational Specialties directly. Recreational Specialties reserves the right to change or alter specifications, including colors, amenities, and changing standards and options - without notice or obligation to Recreational Specialties.

MOAB

1025 E. Waterford
Wakarusa, Indiana 46573
ph. 574-900-1998
www.theMOABproject.com

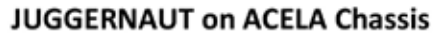

Date: 11.1.23

Note: This is the Manufacturers Suggested Retail Pricing.
Like when purchasing a new car, you will negotiate your best
price with the selling dealer.

Recreational Specialties Representative Signature _____ Date _____

MIGAB

TRAILBLAZER

EXTREME OFFROAD - OFFGRID MOTORHOME

CHASSIS -

- 550 Chassis with 4X4
- 6.7L V8 Diesel Engine w/10 Speed Transmission
- 19,500 GVWR
- Engine Block Heater, Dual Fuel Tanks, 350 Amp Alternator
- FOX Racing Shocks and Springs w/3" Lift
- 35" Tires on 20" Black-Out Rims
- Cameras: Back-up/left/right turn viewing on 7" viewing screen
- Factory In-Dash Stereo System
- Heavy Duty Front Bumper and Steel Rear Bumper
- Front 15,000 Winch w/Controller
- Nerf Bars
- Pass Thru Between Cab and Habitat
- 7 Pin Trailer Connection
- 2" Receiver at Rear Bumper
- Remote Start

EXTERIOR -

- RS designed body/frame that is self-supporting. Doesn't need a monocoque shell to support itself. Box frame structure is welded and huck fastened together for maximum strength
- Exterior entry/exit with articulating step
- Grab handle and railing at entry door for extra convenience
- Full Basement w/Compartment Doors
- Fully painted body to match truck
- All tanks are easily accessible through exterior storage doors
- All components are self-contained within the structure of the shell, allowing the habitat to be unbolted from chassis

EXTERIOR LIGHTING -

- 52" LED light bar on front of cab
- LED tail and brake lights, upper and lower, & marker lights
- LED reverse lights
- LED rear license plate light
- Fog lights
- OEM driving lights
- 3-LED 12" security lights

INTERIOR -

- Large dining table with seating for 6, converts to a King Bed
- High ceilings w/premium soft touch headliner
- Closet w/shelves and hanging rod
- Under dinette storage
- Cab over storage
- Commercial grade flooring for easy cleaning

INTERIOR Cont'd. -

- Premium seating material
- Commercial grade laminate cabinets w/soft close mechanism
- Push button latches
- Solid surface countertops throughout
- Cabover Bunk with Escape Hatch

INTERIOR LIGHTING -

- Zoned lighting throughout
- Independent on/off switches for overheads, bathroom, dinette, kitchen and outside security lights

GALLEY -

- Residential style stainless-steel sink w/ large faucet
- Under cabinet storage for trash can
- Residential style solid surface countertops
- Removable-double burner induction cooktop. Take outside and plug in at your convenience
- Convection microwave/oven
- Refrigerator/freezer
- Exhaust hood
- Overhead cabinet storage
- Base cabinet storage
- Washer/dryer cabinet with pull out storage drawer
- Countertop space with outlets for charging computer or coffee pot
- Wall mounted Smart TV
- Ceiling skylight for roof access above dinette table

BATHROOM -

- Residential style, fully dry, enclosed bathroom with toilet
- Residential style walk-in shower
- Vanity mirror
- Floor to ceiling storage cabinet beside toilet
- Lower cabinet storage w/pass-through to rear exterior storage
- Removable shower wand on height adjustable slide bar
- Sink with premium fixtures
- Premium toilet paper holder
- Shower has skylight for extra lighting and head room
- Variable speed exhaust fan with rain cover

MOAB

TRAILBLAZER

EXTREME OFFROAD - OFFGRID MOTORHOME

INDUSTRY LEADING OFF-GRID ELECTRICAL SYSTEM -

- **48 Volt Energy System.** NOTE: Our 48 Volt System is 2 Times more efficient than leading competitors 24 Volt systems and 4 times more efficient than a 12 Volt system!
- **50 Amp Service**
- **6000 Watts** of inverter power
- Available Run Time:
 - Max A/C- Leading industry at **21 Hours**
 - Running Full System (Heater, A/C, Microwave, Cooktop, etc.) at **10 Hours** (Solar/Alternator/Shore power adds additional time)
- Recharge Time if operating at full capacity, **Less than 5 hours**
- Recharge Time if operating at full capacity with sunlight/solar, **just over 3 Hours**
- **17 Kilowatts**-Energy Storage System
- **Two (2) 8440Watt** Hour Module Lithionics UL listed Lithium-Ion Batteries
- **1.5 Kilowatts**-**Mertin Flexible Solar Panels** for supplemental charging
- Market leading remote interface w/ Bluetooth and Wi-Fi based app
- Victron Touch screen control panel provides state of the art system control and monitoring
- 120V AC outlets located in front overhead, dinette, kitchen, washer/dryer cabinet, bathroom and storage area
- 20 Amp AC outlet in compartment

TANK CAPACITIES -

- 75 Gallons of Fresh Water
- 40 Gallon waste tank
- 30 Gallon grey tank

AIR CONDITIONING, HEATING, & VENTILATION -

- Nomadic Cooling, 3000 48 Volt A/C, 12,480 BTU; Comes standard with 48 Volt brushless motor; Highly efficient while Reducing noise and Increases motor life
- Two (2) thermostat controlled toe kick heaters
- Dual pane windows fully open to bring the outside in
- Roof hatch with vent fan, screen and escape hatch

PLUMBING -

- One (1) 75 Gallon self-contained and heated fresh water holding tanks w/manual drain valve (total 75 Gallons of fresh water)
- 40 Gallon self-contained and heated waste black tank w/manual drain valve
- 30 Gallon self-contained and heated waste grey tank w/manual drain valve
- Tank monitoring system
- High-capacity water pump
- Water heater
- Exterior shower with hot and cold water

SAFETY -

- Carbon Monoxide/smoke detector
- Fire extinguisher
- Roadside safety kit

ACCESSORIES -

- Fresh water hose
- Waste tank hose
- 50 Amp shore cord

Contact your Dealer or MOAB for more detailed information. Ask about customizing your coach if you see anything you may want that we do not currently offer.

The information contained in this promotional brochure was put together using the latest information available at the time of printing. For the most up to date and current specifications, contact your nearest dealer or Recreational Specialties directly. Recreational Specialties reserves the right to change or alter specifications, including colors, amenities, and changing standards and options - without notice or obligation to Recreational Specialties.

MOAB

1025 E. Waterford
Wakarusa, Indiana 46573
ph. 574-900-1998
www.theMOABproject.com

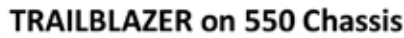

Date: 11.1.23

Note: This is the Manufacturers Suggested Retail Pricing.
Like when purchasing a new car, you will negotiate your best
price with the selling dealer.

Dealer:	Contact:
Address:	City/ST/Zip:
Email:	Ph:

[illegible]

TOTAL:	\$394,000.00
--------	--------------

Freight - DA / CPU / DPU (no pre-delivery)		F.O.B. Wakarusa, Indiana
Customer Pickup / Pre-delivery Orientation (In addition to CPU)		\$500.00

Terms and Conditions: 40% Down to Activate Order. 40% Milestone Payment at 50% Completion. 20% Due Upon Delivery.

Customer Signature

Date _____

Recreational Specialties Representative Signature

Date _____



www.theMOABproject.com

Made proudly in the U.S.A.
1025 E. Waterford • Wakarusa, IN 46573

Email us at: discover@theMOABproject.com